

Light-duty Ball-lock Big nose Ejector

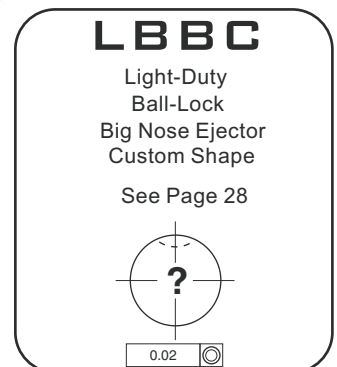
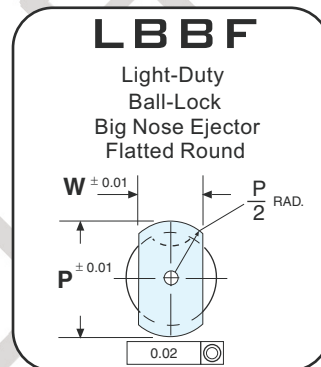
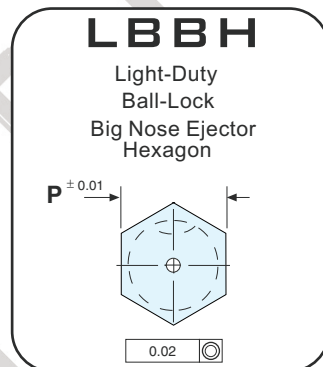
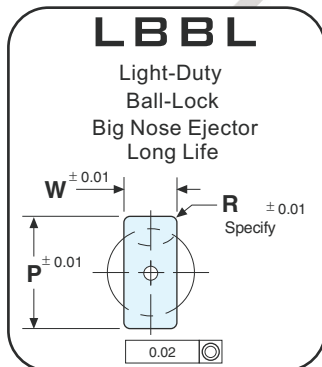
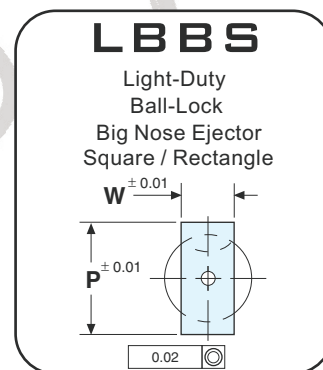
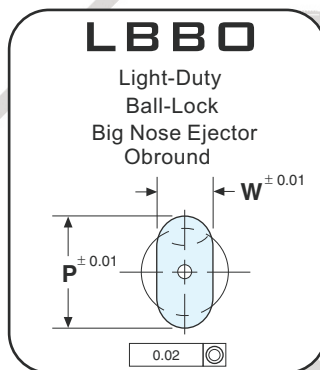
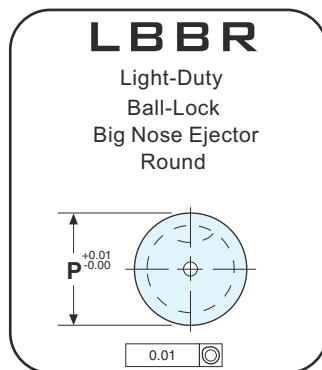
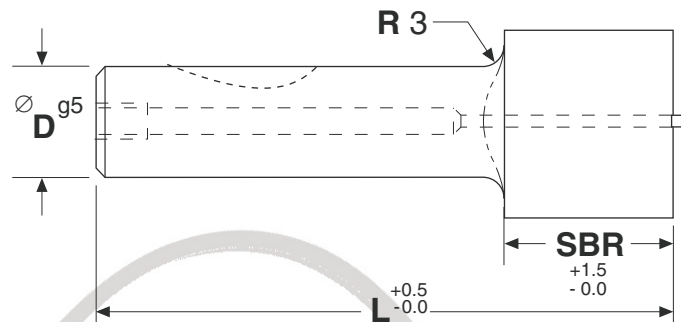
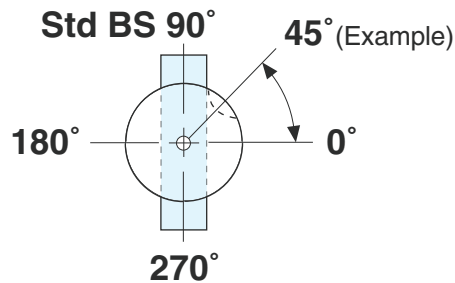

SKD11/D2 Steel - HRC 60-63
SKH51/M2 Steel - HRC 60-63

BEP Code	"D"	Point Length "SBR"	Overall Length "L"				Min. "P"	Min. "W"	Max. "P"
			71	80	90	100			
LBB_	10	16	71	80	90	100	10.1	4.5	22.0
LBB_	13	20	71	80	90	100	13.1	5.0	32.0
LBB_	16	25	71	80	90	100	16.1	6.5	38.0
LBB_	20	25	71	80	90	100	20.1	8.0	38.0
LBB_	25	25	71	80	90	100	25.1	11.0	45.0
LBB_	32	32		80	90	100	32.1	12.5	50.0