

Recycling inserts BT01

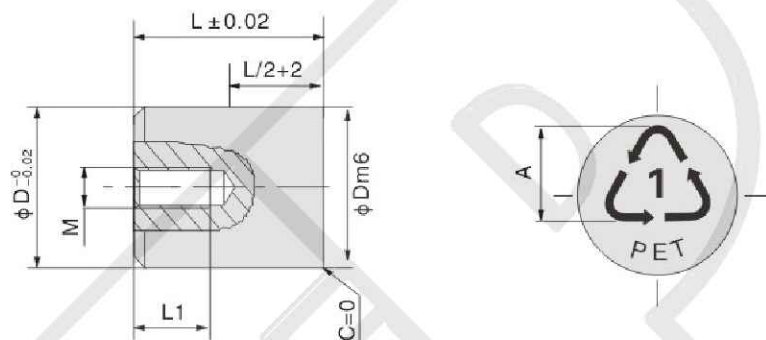















- Environmental protection stamp indicates indication sign to recover plastic products due to those reasons, such as the age and decrease of quality, etc.
- It indicates grade of plastics, which is convenient to classify indications or trademark or other characters or patterns needed to be indicated when recovery is made, due to those reasons, such as environmental protection of products, etc.
- Copper recycling insert is suitable for thin-walled mold plastic products, because the heat dissipation is good.



Type	φ Dm6		L	L1	A	M	Depth of characters
BT01	4	+0.012 +0.004	6/8	4	2	2x0.4	0.2
	5		8	4	3	2x0.45	
	6		8/10	5	4	3x0.5	
	8	+0.015 +0.006	10	6	5	4x0.7	
	10		12	6		4x0.7	
	12		12	6		5x0.8	
	12	+0.018 +0.007	14	6	6	5x0.8	0.3
	16		12	7		5x0.8	
	20		14	7		5x0.8	
		+0.021 +0.008	14	7	10	6x1	
			16	7		6x1	
			14	8	12	6x1	
			16	10		6x1	

Applicable resins::

Polyethylene terephthalate	High density polyethylene	Polyvinyl chloride	Low density polyethylene	Polypropylene	Polystyrene	Other resins
						
			 			



Order: Type No. x Pcs
BT01 x 10

Date Stamp Series

Date stamp of screw die casting die BT02

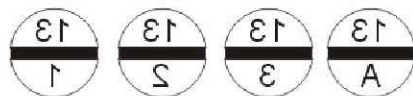

Date stamp of die casting die, only to directly process mounting hole on the die and replacement is convenient.

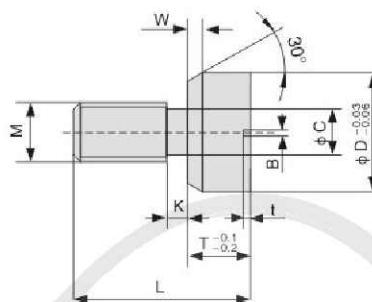

• Installation diagram

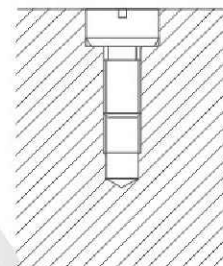

Type	$\phi D_{-0.03}^{-0.06}$	ϕC	K	W	$T_{-0.1}^{-0.2}$	M	L	B	t	Depth of characters
BT02	$\phi 6$	$\phi 2.4$	1.0	1.0	3.2	3×0.5	10	1.0	1.0	0.3
	$\phi 8$	$\phi 3$	1.5	1.0	4.2	4×0.7	12	1.0	1.0	
	$\phi 10$	$\phi 4$	2	1.0	4.2	5×0.8	12	1.2	1.2	
	$\phi 12$	$\phi 5$	2	1.2	5.2	6×1	15	1.2	1.2	
	$\phi 16$	$\phi 6.5$	2.5	1.5	6.5	8×1.25	20	1.2	1.2	



Order: Type No. x Pcs
BT02 x 10

Multi date stamp ZZ4863 ZZ4864

B.HASCO/T

ZZ4 863/...

ZZ4 864/...



This date stamp is a component with year, month, day and recycling insert, the perfect combination, full use of space, applied to the production control.

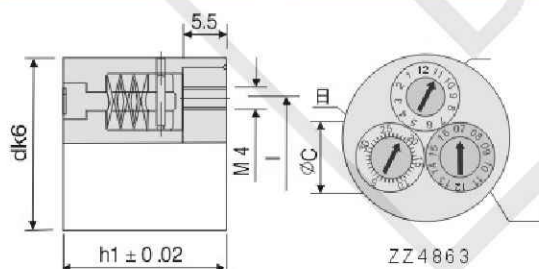

ZZ4 863

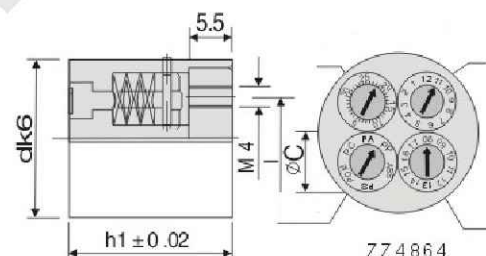

ZZ4 864

Type	Size			
	d	h ₁	l	c
ZZ4863/28	28	25	16	12
ZZ4863/32	32		18	14
ZZ4863/36	36		22	16

Type	Size			
	d	h ₁	l	c
ZZ4864/32	32	25	18	12
ZZ4864/36	36		22	14
ZZ4864/40	40		26	16



Order: Type No. x Pcs
ZZ4864/32 x 10

BRAHMADEVI ENGINEERING PRODUCTS

Regd. Office :19, Martand Chowk, INDORE - 452 007 (M.P.) INDIA
Ph. : +91 - 731 - 2720243, Fax : +91 - 731 - 2721554
E-mail : ishan1809@yahoo.com, ruchir@diepares.com Website : www.diepares.com

Die casting die date stamp BT03



- Special date die-casting mould chapter
- The outer ring of a knockout punch each digital gap at point for date marking

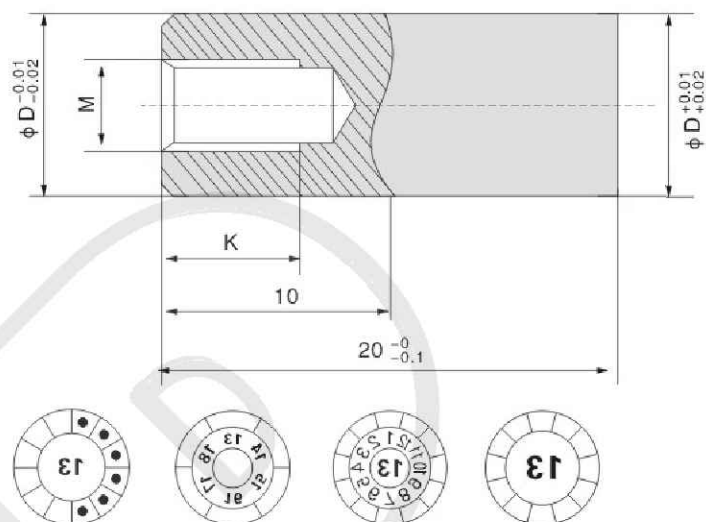

Type	$\phi D \begin{smallmatrix} +0.02 \\ +0.01 \end{smallmatrix}$	K	M	Depth of characters	Depth of groove
BT03	$\phi 8$	6	3x0.5	0.3	1
	$\phi 10$	7.5	4x0.7		
	$\phi 12$	9	6x1		



Order: Type No. x Pcs
BT03 x 10

- Installation diagram

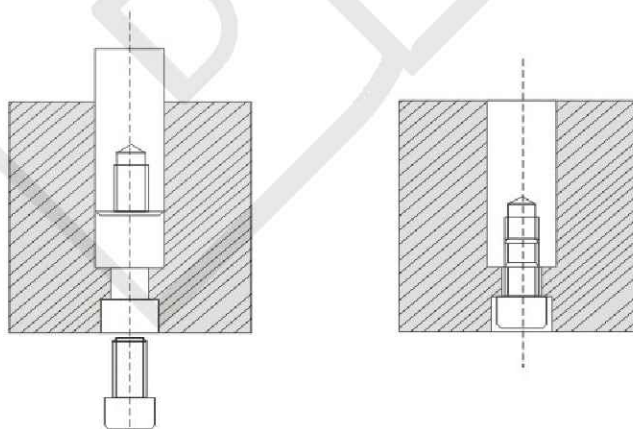

Date Stamp Series



Die casting die date stamp BT04



Die casting die used date chapter, can be used alone, can also be installed using the base standard, convenient replacement.

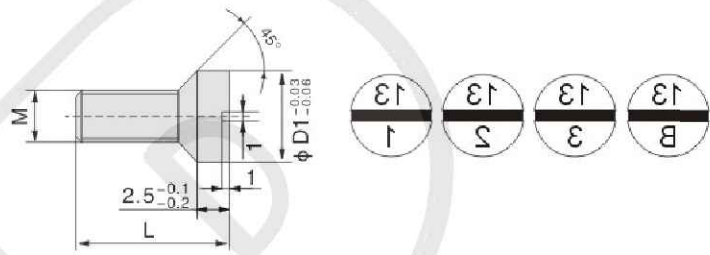
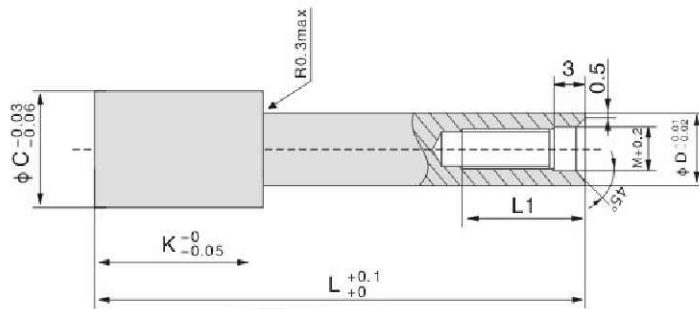

Type	$\phi D1 \begin{smallmatrix} -0.03 \\ -0.06 \end{smallmatrix}$	M	L	Depth of characters
BT04-1	$\phi 6$	M3x0.5	10	0.3
	$\phi 7$	M4x0.7	12	
	$\phi 8$	M8x0.8	15	
	$\phi 10$	M6x1	18	
	$\phi 12$	M8x1.25	20	

Type	$\phi D \begin{smallmatrix} -0.01 \\ -0.02 \end{smallmatrix}$	M	$\phi C \begin{smallmatrix} -0 \\ -0.3 \end{smallmatrix}$	L1	$K \begin{smallmatrix} -0 \\ -0.05 \end{smallmatrix}$	$L \begin{smallmatrix} +0.1 \\ +0 \end{smallmatrix}$
BT04-2	$\phi 6$	M3x0.5	$\phi 10$	10	L/2-5	20-160
	$\phi 7$	M4x0.7	$\phi 12$	12		
	$\phi 8$	M8x0.8	$\phi 13$	15		
	$\phi 10$	M6x1	$\phi 15$	18		
	$\phi 12$	M8x1.25	$\phi 18$	20		



Order:

Type No.

x

Pcs

BT04 x 10

• Installation diagram

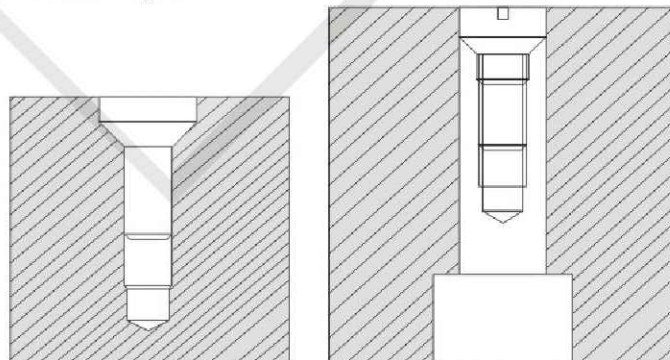

BRAHMADEVI ENGINEERING PRODUCTS

Regd. Office :19, Martand Chowk, INDORE - 452 007 (M.P.) INDIA

Ph. : +91 - 731 - 2720243, Fax : +91 - 731 - 2721554

E-mail : ishan1809@yahoo.com, ruchir@diespares.com Website : www.diespares.com

Traditional Date Stamp BT05

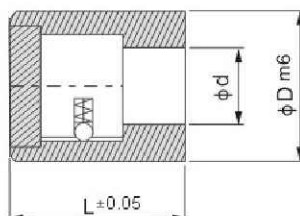

- 1、 It has ball structure with fit tightness;
- 2、 It has accurate arrow indication, and uses ball positioning;
- 3、 It is cost-effective, and easy to assemble.
- 4、 The following specification is subject to BAITO, moreover, it can be processed according to the specification and length proposed by the customers.

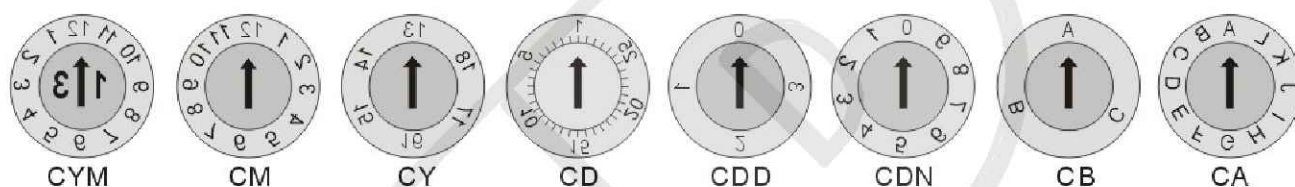

Type								Size
	(1~12)	(13~18)	(1~31)			(A~C)	(A~L)	
—	CM3-6	CY3-6	—	CDD3-6	—	CB3-6	—	φ3-6mm
CYM4-6	CM4-6	CY4-6	—	CDD4-6	CDN4-6	CB4-6	CA4-6	φ4-6/8mm
CYM5-8	CM5-8	CY5-8	CD5-8	CDD5-8	CDN5-8	CB5-8	CA5-8	φ5-8mm
CYM6-8	CM6-8	CY6-8	CD6-8	CDD6-8	CDN6-8	CB6-8	CA6-8	φ6-8mm
CYM6-10	CM6-10	CY6-10	CD6-10	CDD6-10	CDN6-10	CB6-10	CA6-10	φ6-10mm
CYM8-10	CM8-10	CY8-10	CD8-10	CDD8-10	CDN8-10	CB8-10	CA8-10	φ8-10mm
CYM10-10	CM10-10	CY10-10	CD10-10	CDD10-10	CDN10-10	CB10-10	CA10-10	φ10-10mm
CYM10-12	CM10-12	CY10-12	CD10-12	CDD10-12	CDN10-12	CB10-12	CA10-12	φ10-12mm
CYM12-12	CM12-12	CY12-12	CD12-12	CDD12-12	CDN12-12	CB12-12	CA12-12	φ12-12mm
CYM16-14	CM16-14	CY16-14	CD16-14	CDD16-14	CDN16-14	CB16-14	CA16-14	φ16-14mm
CYM20-14	CM20-14	CY20-14	CD20-14	CDD20-14	CDN20-14	CB20-14	CA20-14	φ20-14mm

Statement: if the date stamp haven't the slot to fix, it will random move, also lose the effect of indicating the date.



Order: Type No. x Pcs
BT05 x 10