

Replaceable Date Stamp Z48



Material : SUS420
Hardness : 48°-54° HRc

European German standard

- 1、The inserted parts can't be replaced from the front, and it has main design of hanging appearance;
- 2、It can prohibit the date stamp breaking loose from the front mucous membrane in the injection molding;
- 3、Note: You need to dismantle the mould when replacing this inserted part, and after the inserted part exiting from template, replace it.

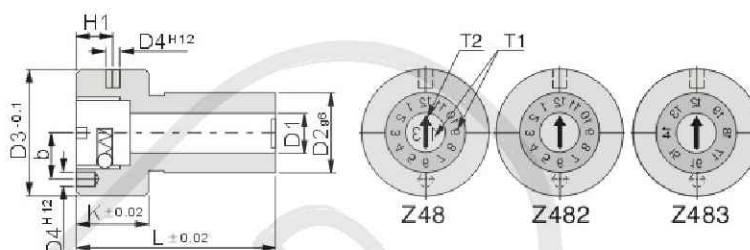

※N stands for displayed number of years.

Month	Month Year	Year	D1	D2	D3	K	L	b	H1	D4	T1	T2
Z48/6/..	Z482/6	Z483/6/..	3.5	6	10	5	14	5	0.9	1.5	0.3	0.5
Z48/8/..	Z482/8	Z483/8/..	4.6	8	12	6	17	6	0.9	1.5	0.3	0.6
Z48/12/..	Z482/12	Z483/12/..	6.5	12	20	10	22	8	3.2	2	0.15	0.9
Z48/16/..	Z482/16	Z483/16/..	9	16	23	11	27	9.25	3.2	2	0.15	0.9
Z48/20/..	Z482/20	Z483/20/..	10.5	20	28	14	36	11.5	4	3	0.15	0.9

Fill in the start year after the model for order.



Order: Type No. x Pcs
Z48/6/.. x 10

Inner Pointer of Date Stamp Z484

Inner pointer can be dismantled, and you can choose different types of inner pointer according to different years.

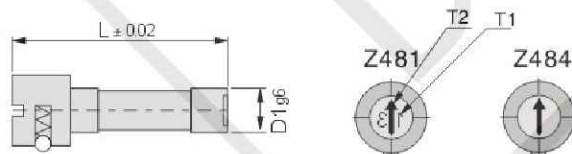

• Installation diagram

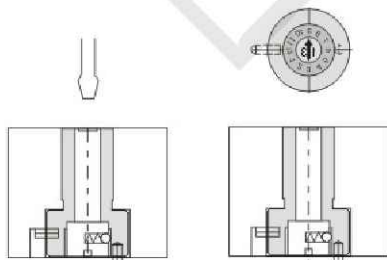

Arrow	Year	D1	T1	T2
Z484/6	Z484/6/..	3.5	0.3	0.5
Z484/8	Z484/8/..	4.5	0.3	0.6
Z484/12	Z484/12/..	6.5	0.15	0.9
Z484/16	Z484/16/..	9	0.15	0.9
Z484/20	Z484/20/..	10.5	0.15	0.9

Please indicate the year in the date.

Date Stamp Series

Replaceable Date Stamp Z4861

German standard

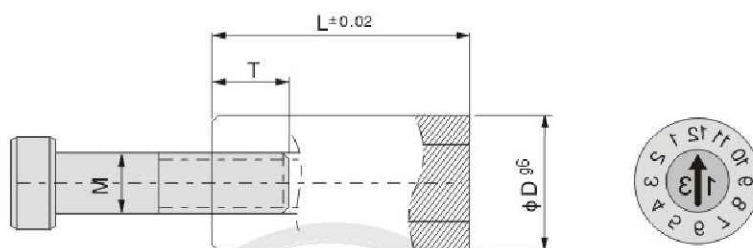

The core of date stamp with whole type material can be changed.
When installing internal insert, anticlockwise rotation is required.
Tail end of date stamp has thread which is convenient for fixing by screw at back end.



Z4861/1



Z4861/2



Z4861/3



Z4861/4

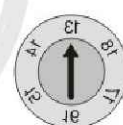

Z4861/5

Materials	Shift	Days	Months	Year	T	M	φ D	L
Z4861/1/4	Z4861/2/4	Z4861/3/4	Z4861/4/4	Z4861/5/4	2.5	2	4	12.5
Z4861/1/5	Z4861/2/5	Z4861/3/5	Z4861/4/5	Z4861/5/5	3	2.3	5	14
Z4861/1/6	Z4861/2/6	Z4861/3/6	Z4861/4/6	Z4861/5/6	3	3	6	16
Z4861/1/8	Z4861/2/8	Z4861/3/8	Z4861/4/8	Z4861/5/8	3	3	8	18
Z4861/1/10	Z4861/2/10	Z4861/3/10	Z4861/4/10	Z4861/5/10	5.5	3	10	22
Z4861/1/12	Z4861/2/12	Z4861/3/12	Z4861/4/12	Z4861/5/12	5.5	4	12	25



Order: Type No. x Pcs
Z4861/1/4 x 10

Installation diagram

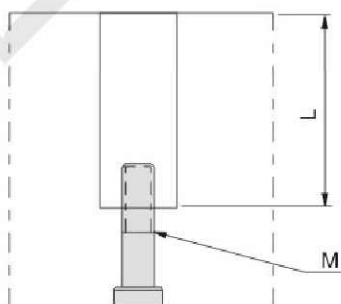

BRAHMADEVI ENGINEERING PRODUCTS

Regd. Office :19, Martand Chowk, INDORE - 452 007 (M.P.) INDIA
Ph. : +91 - 731 - 2720243, Fax : +91 - 731 - 2721554
E-mail : ishan1809@yahoo.com, ruchir@diespares.com Website : www.diespares.com