

Mould Lock Components

MPLK MPLKS Latch Lock



Disc spring, and a combination of internal roller card wheel, can make the opening and closing of the mould has good balance. Wheel rotation can better prevent eccentric wear occurs. The locking sleeve is symmetric, so if the wear can also be installed to use again. Because the back of the locking seat is avoiding vacancy, can also use so the template has the steps.

MPLK

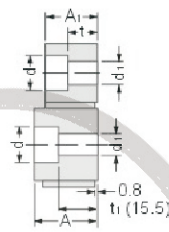
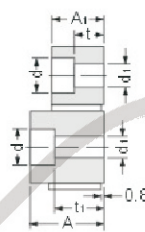
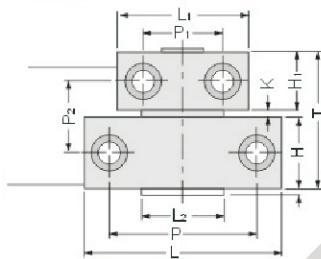

Installation diagram

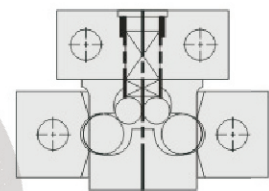

MPLKS

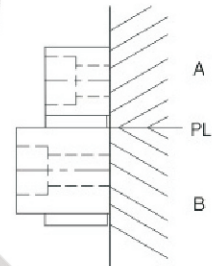
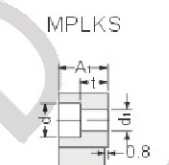
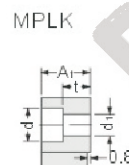
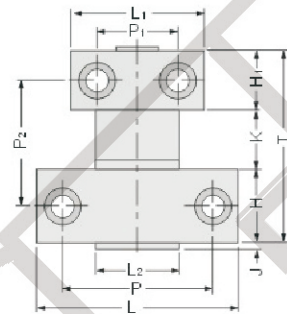

MPLK80

MPLKS80

Type	Size																	(kgf)
	L	L1	L2	T	H	H1	J	K	P	P1	P2	A	A1	t	t1	d	d1	
MPLK	10	48	36	25	42	22	2	2	36	24	22	24	16	9.5	18	11	6.5	50
	20	54	42						40	28				9	16			100
	30	65	46		48.5	25	3.5	3.5	50	31	26						7	150
	60	73	50	35		20	3.5		52	33		27	19	9.5	17	14	9	300
	80S				56.5			11.5			34							400
	100	103	65	48	58	30	4	4	76	42	31	34	25	13	19	17	11	500
MPLKS	30	65	46		48.5			3.5	50	31	26					11	7	150
	60	73	50	35		20	3.5		52	33		24	19	9.5	15.5	14	9	300
	80S				56.5			11.5			34							400

Type	Size																	(kgf)
	L	L1	L2	T	H	H1	J	K	P	P1	P2	A	A1	t	t1	d	d1	
MPLK	60											27			17			
MPLKS		73	50	35	87.5	25	20	3.5	42.5	52	33	65		9.5		14	9	400
	100											24			15.5			



Order: Type No. x Pcs
MPLK x 10

BRAHMADEVI ENGINEERING PRODUCTS

Regd. Office :19, Martand Chowk, INDORE - 452 007 (M.P.) INDIA
Ph. : +91 - 731 - 2720243, Fax : +91 - 731 - 2721554
E-mail : ishan1809@yahoo.com, ruchir@diespares.com Website : www.diespares.com